

NO.257

113th ANNUAL GRANGE FAIR

Saturday August 16, 2025

Open 1:30 p.m. to 7:00 p.m.

Ham & Bean Supper 6:00 p.m.

\$10.00 Adults \$5.00 Children under 10

Tickets on Sale at the Door

Auction - Saturday night begins at 7:15 p.m.

ADMISSION TO THE FAIR IS FREE

**THE MASSACHUSETTS DEPARTMENT
OF AGRICULTURE CO-OPERATING
& THE
MASSACHUSETTS STATE GRANGE**

**BEST WISHES FOR A SUCCESSFUL
2025 ROCHESTER GRANGE FAIR**



508-295-TIRE
4 Thatcher Lane
Wareham, MA 02571

www.usedtirewarehouse.com

We are located in the Industrial Park across from Wareham Crossing

- **New & Used Tire Sales**
- **Tire Repairs**
- **Computerized Balancing**
- **Front End Alignments**
- **Oil Changes**

Various Truck, Trailer & Skid Steer Tires in stock - Call to inquire

BECAUSE EVERYONE RIDES ON USED TIRES...

**ROCHESTER GRANGE
FAIR COMMITTEE**

Chairman.....Herbert L. LaFleur

Secretary.....Susan LaFleur

Treasurer.....Herbert LaFleur

**Set up.....All Members
and Boy Scout Troop #31**

SALES

Food..... Beth Gonneville

Soda..... .Karen Gonneville

Supper..... . Christine Day

Auction.....Thomas Gayoski

FOR INFORMATION CONTACT

**SUSAN LAFLEUR at 508-295-8908
or email sash48@comcast.net**

Please read all instructions carefully
Changes have been made

GENERAL INSTRUCTIONS AND RULES

- 1. Exhibits will be received from 2:00 p.m. to 4:00 p.m. and from 7:00 p.m. to 8:30 p.m. Friday August 16, 2024**
- 2. All entries must be in place 1/2 hour before judging starts.**
- 3. No entries can be removed before 7:00 p.m. on Saturday August 17, 2024**
4. A person shall not offer for exhibit any item not produced and / or prepared by him or herself in the past year.
5. An exhibitor shall make only one (1) entry in any class.
6. New classes shall be listed and judged provided there are three (3) or more entries.
7. Youth exhibits are for boys & girls up to age 16 as of January 1, 2024
8. Undesirable exhibits will not be excepted.
9. Placing shall be awarded on the basis of the quality of an exhibit and the decision of the judge is final.
10. All canned and preserved goods, including jams (except jelly) shall be sealed by processing
11. All perishable goods not called for by 7:15 p.m. will be disposed of or sold at auction. Proceeds will go towards helping to defray the cost of the fair.
- 12. RIBBONS WILL BE AWARDED IN ALL CLASSES.**
- 13. ONLY CLASSES WITH 3 OR MORE EXHIBITS WILL RECEIVE CASH AWARDS**

**NO CANNABIS ENTRIES OF ANY KIND
WILL BE ACCEPTED**

THE COMMITTEE RECOMMENDS

The premium list is your guideline.

1. Save time -make out enclosed entry blank ahead of time.
2. **The fair association is not responsible for loss or damage to exhibits or for injury to persons.**

SOME THINGS THE JUDGES LOOK FOR

Vegetables and Fruits

1. **Exact number** of specimens as called for in premium list.
2. **Uniformity**, all specimen alike in size, shape & color.
3. **Quality**, not to large, not to small, fine texture, etc.
4. **Free from** blemishes, cuts, bruises, insect injury or disease,
5. **Cleanliness**, product washed or wiped as one would to prepare it for market.
6. **ONIONS TO BE UNPEELED.**
7. **STEMS TO BE LEFT ON TOMATOES.**

Canned Goods

1. To be processed.
2. Products should be of the best quality, uniform in size and in good color.
3. The liquid should be clear, free from sediment, of proper consistency and the proper amount in the jar.
4. The containers should be uniform, clean, properly sealed and labeled.

BAKED GOODS

1. Properly wrapped and accompanied by the recipe
2. Attractive, good color, texture and flavor

CLOTHING AND CRAFTS

Condition of article, construction and design,
workmanship, color and ease of care

PREMIUM LIST

The Department of Agriculture may allot prize money awarded on this list pending legislative approval, in addition to Rochester Grange funding.

All entries to be grown, selected & arranged by exhibitor.

All Classes open to all adults and youth beginning at age 5

VEGETABLES

DISPLAYS

1st - \$6.00

2nd - \$5.00

3d - \$4.00

**At least 5 varieties of vegetables arranged
in appropriate container.**

PLATES

1st - \$5.00

2nd - \$4.00

3rd - \$3.00

Beans, green, 15 pods - stem on

Beans, yellow, 15 pods- stem on

Beans, horticultural, 15 pods- shell on

Beets, with 1 inch stem - 5

Cabbage - 2 heads - green

Carrots, short, up to 6 inches - 5

Carrots, long, over 6 inches - 5

Corn, sweet, 1/2 husk removed - 5 ears

Cucumbers - 2

Cucumbers - 5 - pickling

Muskmelon - 2

Onions, white - 5 } unpeeled

Onions, red - 5 } unpeeled

Onions, yellow - 5 } unpeeled

Peppers, labeled as sweet red - 5

Peppers, labeled as sweet green - 5
Peppers, labeled as hot - red -5
Peppers, labeled as hot - green - 5
Potatoes, white - 5
Potatoes, red - 5
Pumpkins, pie type - 2
Egg Plant - 2
Squash, yellow summer - 2
Squash, green summer - 2
Squash - Butternut - 2
Squash - other winter variety - 2
Tomatoes, red -5 {stems on
Tomatoes, green - 5 {stems on
Tomatoes, labeled as pear or plum - 5 {stems on
Tomatoes, labeled as cherry or Husk 10 {stems on
Non classified vegetables

1st - \$5.00

2nd - \$4.00

3rd - \$3.00

Largest Pumpkin in size
Largest Summer Squash in size
Largest Winter Squash
Largest Watermelon in size

FRUITS PLATES

1st - \$5.00

2nd - \$4.00

3rd - \$3.00

5 Apples name variety
5 Pears name variety
5 Peaches name variety
1 Pint Blueberries
1 Pint Cranberries
Any Non classified fruit

CANNING

All canning must be this year's production. Labels must be uniform. Jars shall be the same size and type. Products shall be sealed by processing, except jelly.

1st - \$5.00

2nd - \$4.00

3rd - \$3.00

VEGETABLES 2 jars each
Snap Green or Yellow Beans
Whole Beets
Sliced Beets
Pickled Beets
Tomatoes
Tomato Sauce

FRUITS 2 jars each
Blueberries
Peaches
Pears - Halves
Applesauce

PICKLES & RELISH 2 jars each
Bread & Butter Pickles
Sour Pickles
Dill Pickles
Relishes or Piccalilli
Salsa

JELLY/JAM/MARMALADE 2 jars each
1 flavor Jam
1 flavor Jelly
1 flavor marmalade
Any Unclassified

**Display of at least 5 different varieties from
a category, such as 5 types of pickles or 5 flavors of jelly.**

**All exhibits in these classes must be made by
exhibitor the last 12 months.**

1st - \$5.00

2nd - \$4.00

3rd - \$3.00

NEEDLEWORK

Child's sweater - specify knit or crochet

Sweater - Adult - specify knit or crochet

3 piece Baby Set - specify knit or crochet

Embroidered item

Other

HOME FURNISHINGS

Afghan -specify knitted/crocheted

Quilt - specify adult or baby

Hooked Rug - specify latch or regular

Doilies

Pillow

Any other

ARTS AND CRAFTS -

Label paintings as to what medium

Painting - Oil

Painting - Water color

Dressed Doll

Wreath - handmade

Small Wood Crafts\Toys

Basket

Jewelry

Christmas Ornaments

Other

MOUNTED PHOTOGRAPHS

Scenes from anywhere

People

Animals

FOOD

All entries must be made by the exhibitor.

RECIPES MUST ACCOMPANY ALL ENTRIES.

They are to be wrapped in clear plastic.

IF USING NUTS PLEASE LABEL CLEARLY

1st - \$5.00

2nd - \$4.00

3rd - \$3.00

Baking Powder Biscuits - 7

Quick Bread from scratch or modified package mix

Pound Cake Angel or Sponge Cake

Decorated Cake or 7 Cupcakes

Coffee Cake

2 Crust Pie

Single Crust Pie

Muffins - 7

Brownies - 7

Favorite Holiday Cookies - 7

Fudge - 7pc.

Any Other

EGGS

1 Doz. White , Brown or Other

FLORAL ARRANGEMENTS

Must be selected and arranged by exhibitor

PLEASE LABEL WHAT CATAGORY

Wildflowers and /or fruit & foliage

In a metal container for color & harmony

Arrangement for table or against wall

Dry Arrangement

Container not meant for flowers

Floating plant material in shallow container

Any other

HOUSE PLANTS

1st - \$5.00

2nd - \$4.00

3rd - \$3.00

African Violets - single

African Violet – double

Begonia - Fibrous, tuberous or Rex

Philodendron

Spider Plant

Any Hanging - needs to sit on flat surface (edge of stage)

Any Other - non classified

CUT FLOWERS

Flowers must be grown, selected and arranged in an appropriate container. To be judged for horticultural perfection. Cut flowers should include sufficient stem and foliage when practical.

PLACE YOUR NAME ON BOTTOM OF CONTAINER

1st - \$5.00

2nd - \$4.00

3rd - \$3.00

Asters - 5 blooms

Cosmos - 5 blooms

Dahlias - 5 large blooms

Dahlias - 5 small blooms

Marigolds - 5 blooms large flower

Marigolds - 5 blooms - single

Gladiolus - 5 spikes

Petunias - 5 - single blooms

Petunias - 5 - double blooms

Zinnias - 5 - giant blooms

Zinnias - 5 - small blooms

Roses - 1 - single bloom

Rose Bouquet - at least 5 blooms

Any Other

CONSERVATION

CHILDREN UP TO 14 YEARS OLD

**Exhibits to have been made within the last year.
Aug. 2021-Aug. 2022**

1st - \$5.00 2nd - \$4.00 3d - \$3.00

**COLLECTIONS - All displays
should be mounted on poster-board
or cardstock no larger than 11 x 18.
All specimens should be neatly
labeled. Please write name and age
on the back.**

**The 5 categories for collections are:
Collection of 5 Common Wildflowers
Collection of 5 Insects
Collection of 5 Sea Shells
Collection of 5 Feathers**

**Bird Feeder - Use items found in nature & the
home (pine cones, gourds, recycled containers,
etc.)**

ROCHESTER GRANGE #257 ANNUAL FAIR REGISTRATION FORM

NAME _____ **AGE** _____

ADDRESS _____

PHONE NUMBER _____

Code #	Description
--------	-------------

[illegible]

ROCHESTER GRANGE #257 ANNUAL FAIR REGISTRATION FORM

NAME	AGE
------	-----

ADDRESS _____

PHONE NUMBER _____

Code #	Description
--------	-------------

[illegible]



**AUTOMATIC
POOL COVERS
NEW ENGLAND**

781-4-A COVER

www.automaticpoolcoversnewengland.com

SOUTH MIDDLEBOROUGH GRANGE #337
67th ANNUAL OUTDOOR AGRICULTURAL FAIR

Saturday, August 23, 2025

South Middleborough Grange, 570 Wareham Street, South Middleborough

Fair exhibits received from 7 a.m. - 11 a.m.

Judging at 11 a.m. Exhibits on display until 5 p.m.

Baked goods sale

**Modified Classes: Flowers, Fruits, Vegetables, Honey, Eggs
and Youth Conservation Posters only**

Visit <http://www.massgrange.org> to obtain the complete list of classes

Questions to purchademeadows@yahoo.com or call/text (774) 419-2938

**IN COOPERATION WITH THE
MASSACHUSETTS STATE GRANGE
&
COMMONWEALTH OF MASSACHUSETTS DEPARTMENT OF
AGRICULTURAL RESOURCES (MDAR)**



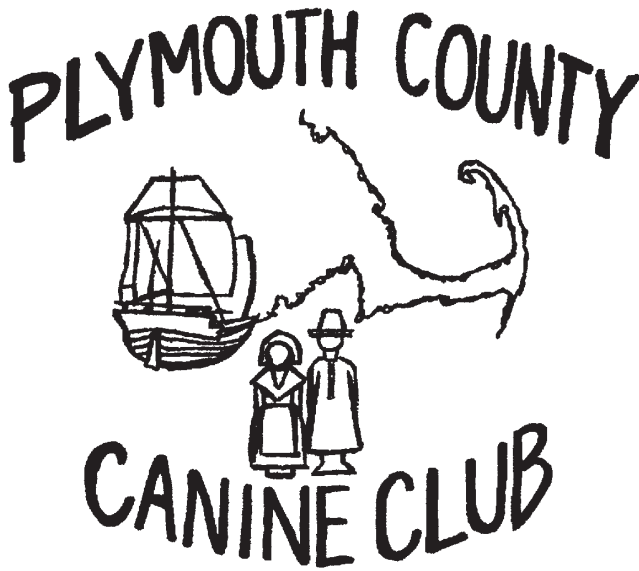

PLYMOUTH COUNTY CANINE CLUB

Offers Obedience Training with Ed Dupont
Friday nights at the Rochester Grange

8 week beginner class at 7 pm
Drop-in advance class at 8 pm

FMI call Sherri Swindle at (508) 930-4889
or Ed at (508) 763-3355



Headquarters Taxidermy
Jim Holden
Licensed Professional Taxidermist

P.O. Box 388
67 Neck Rd., Rochester, MA 02770

Phone (508) 763-8571
Showroom on Site
By Appointment Please
50% Deposit Required

After 36 years in the business,
I will now only be taking in
Gameheads and Turkey Boards

www.headquarterstaxidermy.com



508-758-3847

98 County Road, Rte 6
Mattapoisett, MA 02739

HARTLEY SAWMILL

267 Vaughan Hill Rd.
Rochester, MA

(508) 763-2582

native lumber
picnic Tables

Since 1888

CAPT. BONNEY'S CREAMERY



258 NEW BEDFORD RD.
ROCHESTER, MA

OVER

50 FLAVORS OF ICE CREAM
SOFT & HARD SERVE

2 STEAMED HOT DOGS -DRINK-CHIP

LINGUICA DOGS • CHICKEN SALAD

ITALIAN MEATBALLS

YANKEE POT ROAST

LOBSTER ROLL

GRILLED SANDWICHES

AND WRAPS

OPEN DAILY 11AM - 9PM

774-218-3586

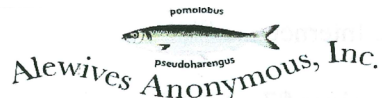

P.O. Box 42 • Rochester, MA 02770

The Herring Helpers

Dedicated to the preservation and increase of the alewife fishery resources in the Mattapoisett River and the Sippican River in the towns of Rochester, Marion & Mattapoisett, MA

**We invite you to *PLEASE*
join and help support our efforts**

Annual membership: \$10.00

Arthur F. Benner phone 508-763-2024
President artbenner@comcast.net

Jay San Gas Service Inc.

A Gas Check Company

SINCE 1976

- Complete Sales & Service
- LP Gas & Appliances
- Grill Tanks Filled
- Fork Lift Tanks Filled
- 24 Hour Emergency Service
- Open Mon.-Fri 8-5
- Closed 12-1 For Lunch

**Office & Showroom at
80 County Rd, E. Freetown**



GAS CHECK

763-2729

The Best in Antique Woodstoves
Sales - Restorations - Parts
Cook Stoves - Parlor Stoves - Base Burners

Wilson's Woodstoves
780 Snipatuit Road
Rochester, MA 02770
508.763.8941
wam780@yahoo.com

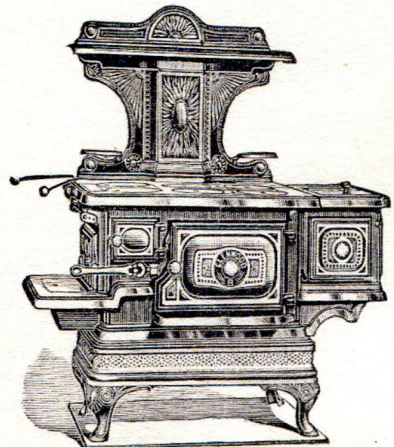

Long Plain Service Machine Shop

1142 MAIN STREET
ACUSHNET, MA 02743
TEL (508) 763-2676

Custom-Drive Shafts • Welding
General Machine Work • Fabrication

Andy Harding & Daughter



The *Wanderer*

Serving Mattapoissett, Marion, Rochester since 1992

Read the latest TriTown news on line at

www.wanderer.com

55 County Road, P.O. Box 102, Mattapoissett
(508) 758-9055 • FAX (508) 758-4845

ROCHESTER HISTORICAL SOCIETY MUSEUM

355 County Road

Open House October 4th

Yard Sale August 2nd & 3rd



MURPHY'S AUTO SALVAGE, INC.

35 County Road
West Wareham, MA 02576

Recovery & Towing
24 Hour Service
Used Cars & Trucks

New & Used Auto Parts
Auto & Truck Repairs

AAA & Cross Country Towing Services

Tel (508) 295-8697
Fax (508) 295-4488

Nourish Your Body Inside and Out



JONATHAN
SPROUTS™
Nature meets science

Jonathan Sprouts Skincare

Jonathan Sprouts' skincare was **created** featuring our broccoli sprout extract and 21 herbal blend; key essentials for the body's largest **organ**—our skin! Handcrafted in small batches and available worldwide, we practice sustainable hydroponic farming using no soil or disruption of the earth's surface. Through our continual commitment to farm fresh green beauty practices, we deliver superior products.

Jonathan Sprouts is the first produce company to cross the produce aisle to skincare.



www.jonathansprouts.com

Follow us on Instagram and Facebook @jonathansprouts

**RIDING
SEASON
IS HERE!**



REPAIRS, PARTS, MAINTANANCE



HOURS OF OPERATION

MONDAY, TUESDAY, THURSDAY, FRIDAY 10:00AM-6:00PM
SATURDAY 10:00AM-5:00PM

More Information

📞 508-295-1522
✉ capecodchoppers@gmail.com
📍 2554 Cranberry Hwy,
Wareham, Ma 02571

Contact Us





ROCHESTER BOY SCOUTS TROOP #31
WOULD LIKE TO THANK THE
ROCHESTER GRANGE AND THE
TOWN OF ROCHESTER FOR THEIR
CONTINUED SUPPORT



Insured

TOM FERGUSON
GENERAL CONTRACTOR

Building & Remodeling
Residential • Commercial • Industrial

Established 1987
Lic. #048745

(508) 763-5191
Rochester, MA

Koczera *DISCOUNT* **Oil**
HOME HEATING OIL

763-9504
MICHAEL KOCZERA

4 Robinson Road
Rochester, MA 02770

MHT Excavating

Serving the South Coast and beyond since 2005

Specializing in all phases of site work, septic systems, drainage, utility installations and more
for residential and commercial clients.

508-758-8427 ~ www.MHTExcavating.com

**In loving memory of
Elizabeth Florindo
and her daughter
Christine Florindo
“Not to be Forgotten”**



LM Leo's Machine & Welding, Inc.

- Specializing in Custom Work -

Lathe Work 30" x 18' • Cylindrical Grinding 10" x 27"
Surface Grinding 16" x 32" • Blanchard Grinding 42" • CNC Lathe
CNC Vertical Machining • Fabrication: Aluminum • Steel • Stainless

James Fortin – Owner

1091 Main Street
Acushnet, MA 02743

Tel: (508) 995-3300
Fax: (508) 995-5729

Email: leosmachine1091@aol.com



SOUTHCOAST
AGRICULTURAL
SERVICES



S O U T H D A R T M O U T H , M A



RUSSELLS MILLS

• FLOWER COMPANY •



East Over FARM

Horseback Riding

Flower Stand

Wellness Center

Kids Programs

www.eastover.farm



- Breads & Pastries
- Baked on the Premises
- Sandwiches Made to Order
- Catering to all Occasions

JENNIFER SOUSA

Tel: (508) 758-9408

Fax: (508) 758-4993

67 County Road
Mattapoisett, MA 02739

[shipyardgalley@gmail](mailto:shipyardgalley@gmail.com)

Look us up on Facebook



Thank You

COME VISIT US!



119 Wareham
Road Marion MA

657.544.1023

jsullwine.company.site

jsullwine@gmail.com

FEATURED WINES:

Bonanza Cabernet

\$19.99 750 ml

Romance Rosé

\$16.99 750 ml

Coppola Shimmer

\$10.99 MUST TRY!

Open Mon - Fri 9-6pm Sat 9-5pm

Closed Sundays



fresh cut premium christmas trees
hand-crafted and custom-made
holiday wreaths, roping, and baskets

season begins the week of
November 15th
508.264.1686

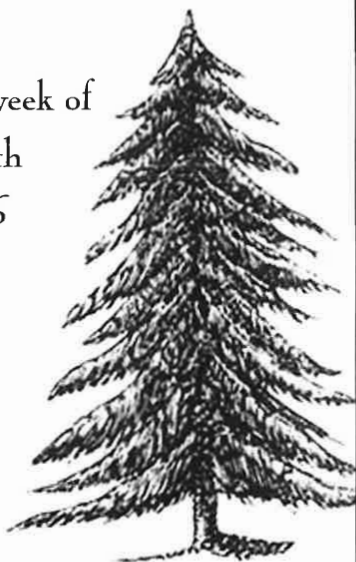

24 HOUR SERVICE

for Hiller Customers

FUEL OIL

■ **L.P. Gas**

**FILLING STATION
HEATING CONTRACTORS**

Quality You Can Trust from a Local Dealer

HILLER FUELS INC.

748-0020

Used Clothing Drop-Off Shed

Location:

Rochester Grange
205 Hartley Rd
Rochester, MA 02770

Why Donate?

Reduce waste in landfills.
Clothing used worldwide.
Tax deductible.

Only Items Accepted:

All clothing, shoes, sneakers, belts, purses, blankets, towels,
sheets, pillowcases, curtains, and stuffed toys.
(Your donations will be redistributed as whole garments)





EXPIRES



2
0
2
6

*Collision Repairs
Color Matching
State Inspections*

MA INSPECTION STATION NO. 50306

Reg Shop #3406
Appraiser # 13067

THE CUSTOM SHOP

Collision and Glass

45 Pine Street • Rochester, MA 02770

508-763-5777

PURCHASE FARM

74 PURCHASE STREET

NORTH MIDDLEBOROUGH, MA 02346

(508) 947 – 1904

LaCroix Family

purchademeadows@yahoo.com

USDA certified pork and lamb

Proud supporter of Rochester Grange #257

Paints Since 1846

Tel. 997-9008

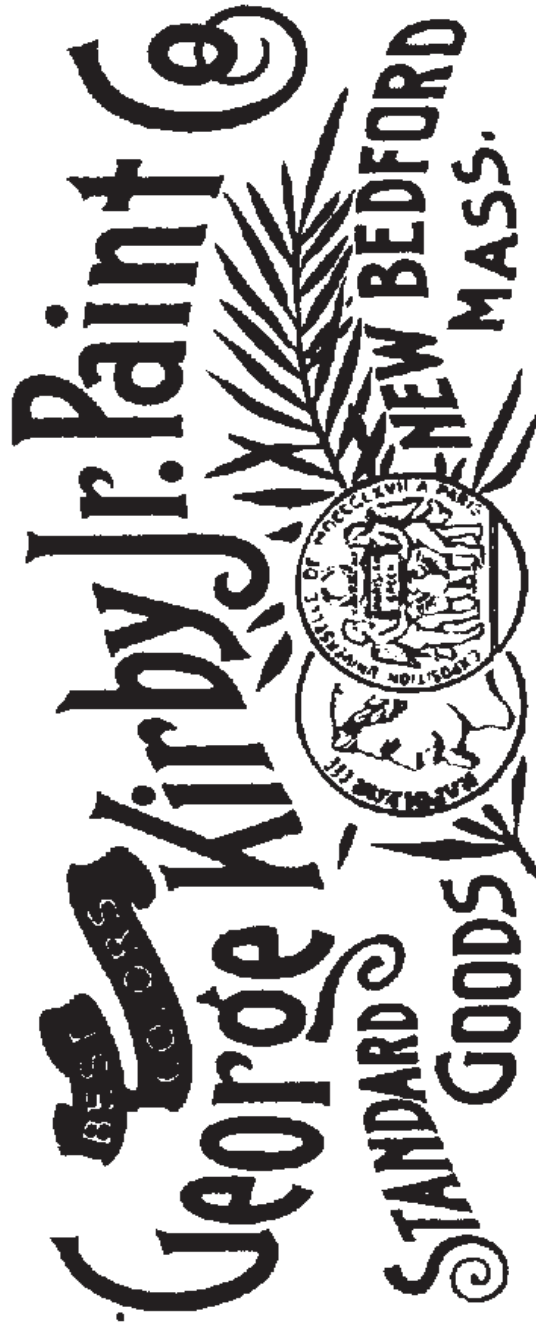

163 Mt. Vernon Street

02740

GEORGE A. KIRBY



Corey & Peter Lorenzo
Owners

508.758.9922

508.758.9923

50 Marion Rd. (Rt. 6)
Mattapoisett, MA 02739

www.OnTheGoTakeout.com



Custom Homes ■ Remodeling ■ Additions

Isabelle Contracting 183 Mendell Rd Rochester, MA 02770-1312

Tel: 508 763-8005

mji@isabelleconstruction.com HIC# 128113



www.sunnynookfarm.com

Sunnynook Farm
32 Neck Road Rochester MA 02770
508-763-5405

Pet and Farm Supplies
Hay Grain Shavings
Supplements

Landscape Materials
Bark Mulch Stone
Sand Compost



Rose & Vicki's

• STONE HEARTH PIZZA •
• BAKERY & SUBS •

Marion 508-748-1333

KNOX ELECTRIC, INC. ACUSHNET, MA.

(508) 995-6469 office phone and fax

Knoxelectric@comcast.net

Electrical Contractor

Residential, Commercial and Industrial
Burglar and Fire Alarms
Generators and Solar

P.O. Box 50117
New Bedford, Ma. 02745

Insured & Licensed
A9629 & E28653



Artisan BAKE SHOP

cakes & confections



Friend us on Facebook

MEREDITH ROUSSEAU

Pastry Chef & Owner

shop phone 508.763.4905

artisanbakeshop@gmail.com

www.artisanbakeshop.com

265 Walnut Plain Road
Rochester, MA 02770

Serving the South Coast, South Shore, Boston, Cape Cod & Islands, Rhode Island



ROCHESTER FIRE FIGHTERS ASSOCIATION

508-763-5203

Hartley Road • Rochester, MA

New Leaf Design



3 Hermitage Road, Marion, MA 02738

508-264-5852

sgonsalves61@verizon.net

Stephen Gonsalves, Owner

Landscape Design/Consultation

Fish Ponds

Walkways/Patios

Low Voltage Lighting

Landscape Installation

DUCHARME HEATING & AIR CONDITIONING

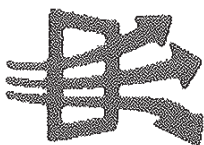

Gas & Oil Heating-Cleaned, Repaired &
Installed - Hot Water & Warm Air
Systems - Gas Piping Systems
Residential & Light Commercial

24hr Emergency Service

FREE ESTIMATES
LICENSED & INSURED

Brian Ducharme
Phone: (508) 996-8336
Emergency: (508) 889-3719



FAIRHAVEN COAL CO.

- Premium Anthracite - Pea, Nut, Rice, or Stove
- Pick-up or Delivered • Bulk or Bag

Answering Machine Pick-Up After Fourth Ring

Fairhaven, MA 02719

TONY LOPES
508-990-0011
Cell: 508-965-6018

ADRIAN'S PACKAGE STORE IN ROCHESTER, MA

Large Selection of Wines

Beer • Liquor
Convenience Items

Brett Sherman, Proprietor
(508) 295-2831

Also Visit Us at Our New Store
Seahorse Wine & Spirits in Mattapoisett



SALES • SERVICE • PARTS

635 MILL STREET MARION, MA 02738

508-748-0019 • HillerCo.com

IN LOVING MEMORY
of
ROBERT SHERMAN
“Friend of the Grange”

Seconds Count!

Quality Resale for the Whole Family



Lifestyles Plaza, 270 Huttleston Ave.
Fairhaven, MA 02719

Mon. - Sat. 9 to 4:30 Thurs. 'til 7:00

(508) 991-2229



Men's, Women's, Junior's, Children's and Maternity Clothing
Handbags, Shoes, Jewelry, Books, Baby Equipment



eden

florist & garden shop

Stunning floral designs
for all occasions

Quality, flowering plants,
trees and shrubs

We rent for tent events.

337 wareham road
marion, ma 02738
508-748-0225

edenofmarion.com

***Individualized care
given with
gentle kindness and respect.
Infants to Seniors.***

**Most Insurance Accepted
(508) 748-6632**

Marion Family Chiropractic

Dr. Jennifer Eames

Dr. Allison Baker



**TIRE MART
BRAKE & MUFFLER CENTER**

Front End Alignment • Shocks • Custom Pipe Bending • Batteries

(508) 947-4700

MASS. STATE INSPECTION

523 West Grove St. Rte. 28 • Middleboro, MA 02346



Tri-Town Barber Shop

119 Wareham Rd, Marion

774-553-5020

Tues-Fri 8am-6pm

Sat 8am-2pm

Closed Sunday & Monday

WE SPECIALIZE IN YOUR AUTO NEEDS

JOEL AMARAL



AMARAL'S

**AUTOMOTIVE
CENTER**

774-849-4860

24 COUNTY ROAD, EAST FREETOWN, MA 02717

MINOR TO MAJOR REPAIRS

TOWING

ASE CERTIFIED

MASS CERTIFIED EMISSIONS REPAIR FACILITY

AMARALSAUTOMOTIVECENTER.COM



Fieldstone

EST • 2016

806 Mill Street
Marion, MA

774-553-5094 | www.fieldstonefarmmarket.com

Family-owned market carrying local produce,
artisan cheeses, craft olive oils, specialty food
items, in-house prepared meals and bakery items,
local ice cream, vegan and gluten free products,
and more!

Market open 9-7 everyday

Ice cream stand open for the season 11-9 everyday



Paul Milde
Peinert Boat Works

46 Marion Road
PO Box 1029
Mattapoisett, MA 02739
Phone/Fax: 508/758-3020
Email: paul@sculling.com
www.sculling.com

COUNTRYSIDE



CHILD CARE CENTER

**Offering Infant, Toddler, Preschool
and School Age Programs**

www.countrysidechildcare.net

High Street Auto & Truck Salvage

USED AUTO & TRUCK PARTS • VEHICLES REMOVED

ROBERT MINARIK
(508) 763-8990

56 HIGH STREET. • PO BOX 155
ROCHESTER, MA 02770

MASS AUTO TUNE

508 995-6979



HAS MOVED TO A NEW LOCATION

RON JASON & ADAM MATTON | 15 NEW BEDFORD RD
AUTO SERVICE & REPAIRS | ROCHESTER MA 02770

FAMILY OWNED & OPERATED SINCE 1979

CSMI

Collision Services

OF MARION INC.

Collision Specialists | Auto Rental Services
Glass Replacement | Expert Painting
Frame Straightening

Family Owned Since 1978

391 A FRONT STREET, MARION | MA REG. #1103

F. 508.748.1320

508.748.1441

KITCHENS • BATHS • DECKS WINDOWS & DOORS ADDITIONS • SIDING & MORE



Fisher & Rocha, Inc.

CUSTOM BUILDERS • REMODELING • REPAIRS

17 Fairhaven Rd. | Mattapoisett | MA 02739

508.758.6738 | fisherrocha.com

FULLY INSURED: HIC LIC #100157



Like us on Facebook



Marion Antique Shop

335 Wareham Road (Rte. 6)

Marion, MA 02738

508-748-3606

www.marionantiques.com

www.marionantiqueauctions.com

open year round

Closed Tues & Wed

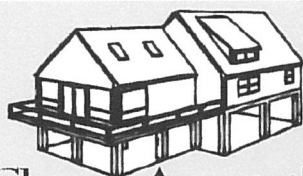

Charon Associates INC.
323 NECK RD., ROCHESTER, MA 02770

- SITE & UTILITY PLANS FOR NEW CONSTRUCTION & ADDITIONS
- FLOOD ZONE FOUNDATION DESIGN
- HIGH WIND ZONE DESIGN & CERTIFICATION
- SEPTIC SYSTEM DESIGN FOR NEW HOMES & TITLE 5 REPAIRS
- PERCOLATION TESTS & SOIL EVALUATIONS

CONSULTING ENGINEERS

T: 508-763-8362 F: 508-763-9582



RICHARD J. CHARON, P.E.
CARMELO NICOLosi, S.E.

ROCHESTER GOLF CLUB



ROUNSEVILLE ROAD - RTE. 105
ROCHESTER, MASS.
PHONE 763-5155



The Weigel Family

Rochester, MA

(508) 889-0065

Oldepostfarm@gmail.com



Barnes Tree Service, Inc.

123 DEXTER LANE

P.O. BOX 489

ROCHESTER, MA 02770

TEL: (508) 763-2553

RES: (508) 758-3342

FAX: (508) 758-6131

Christian J. Consoletti
Owner, Director

email. wvfh@comcast.net
Lic. 6782 Type 3

**Wareham
Village Funeral Home**
& Cremation Service
5 Center Street, Wareham, MA 02571
25 Years of Service

www.warehamvillagefuneralhome.com

Tel: 508-295-4748

Fax: 508-295-4834

**PLUMB MEMORIAL
LIBRARY**
ROCHESTER, MASSACHUSETTS

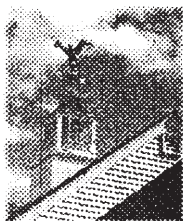

HOURS:

Monday 1:00 – 8:00

Tuesday 10:00 – 6:00

Wednesday 10:00 – 6:00

Thursday 1:00 – 8:00

Friday 10:00 – 5:00

Saturday 10:00 – 2:00

The library is closed on Sundays
and major holidays

17 Constitution Way
P.O. Box 69
Rochester, MA 02770

508-763-8600

FAX 508-763-9593

email:
info@plumblibrary.com

website:
www.plumblibrary.com

online catalog:
www.sailsinc.org

NOTES

South Coast Chapel Mortuary

Funeral & Cremation Services



Choose us for your loved ones.

Here we function by the golden rule.

Hometown Friendliness, Honesty & Compassion

"Where it's always, One Family at a time"



*Simple, Dignified & Affordable Traditional
Funeral and Cremation Packages*



*Christine L. Hatfield, RN
Type 3 Funeral Director & Embalmer*



www.southcoastchapel.com • 508-763-0000

*158 Middleboro Rd. (Rte. 18) P.O. Box 720 • East Freetown, MA
(Diagonally across from St. John Newman Church & Camp Cathedral)*

FRESH

Whole

Fried Clams

The Robin's Nest

Ice Cream

FRESH

Fish & Chips

HARD ICE CREAM • SOFT ICE CREAM

Fish & Chips • Clam Plates • Scallop Plate

Hamburgers • Hot Dogs • French Fries • Onion Rings

Chicken Fingers - Buffalo Nuggets - Mozzarella Sticks

Open 7 Days 11 am - 9 pm

BEST FISH & CHIPS and CLAMS IN TOWN 508-295-6992

Directions:

From Marion, Rt. 105 North, cross Rt. 195, take 1st right (County Road), go 4 miles, go through stop sign, take 1st left, 1/2 mile on Right

from Wareham: Rt. 28 North, take left at Rt. 58 (Wareham Court House) 2nd street on right.

High Street, Rochester - off County Rd, West Wareham

AMEX

OFFER

